

IP 门禁对讲 IS/IV720 安装指南

感谢您购买ESCENE IP门禁对讲设备。所有ESCENE IP门禁对讲产品发货之前都经过严格测试。ESCENE IP门禁对讲设备广泛应用于办公室、学校、机场等。为了方便安装、调节和运行，设置前请仔细阅读本手册。

IP 门禁对讲剖解图

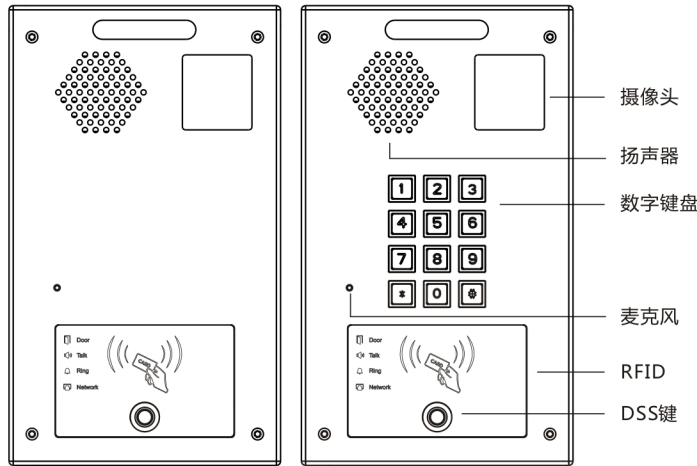

Output 1 电锁 Output 2 告警灯 Input 1 门磁 or 红外探头 Input 2 震动传感 or 紧急按钮

包装清单:

列表	数量
门禁对讲主机	1
快速操作指南	1
安装指南	1
安装尺寸图	1
接线端子	2
螺丝和工具	1包

出厂值IP地址:

该设备出厂值IP地址为静态IP (IP地址192.168.1.100)，网关：192.168.1.1，默认WEB访问用户名及密码均为小写root。为避免网络问题，请仔细阅读配置，然后将设备接入网络环境中。
提示：设备母板有轻触开关，短按一次可播报IP地址，长按3秒可恢复出厂值，恢复出厂值后，所有配置将被删除，请谨慎操作。

<http://192.168.1.100/user.asp> 为后台简易管理页面地址。
<http://192.168.1.100/home.asp> 为后台高级管理页面地址。

SIP 帐号设置:

在简易或高级管理页面，可设置设备SIP服务器地址、端口、用户名、密码和其他SIP帐号相关的设置。

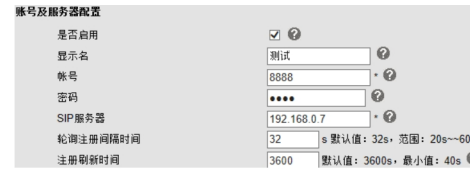

简易管理页面图示

高级管理页面路径：SIP帐号设置>帐号1

账号及服务器配置 > 账号1

当前设备有两路继电器输出和逻辑输入接口，继电器输出接口可以受控于DSS键、逻辑输入、服务器控制、DTMF。

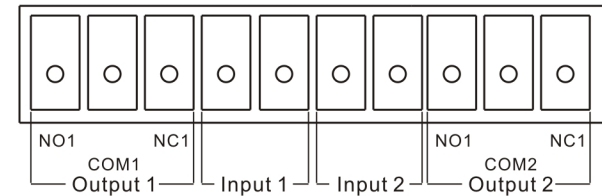

两路短路输出/输入示例图

两路短路输出配置方法:

登陆简易管理页面或高级管理页面，找到如下图所示可对输出口进行设置：

开关量信号输出1

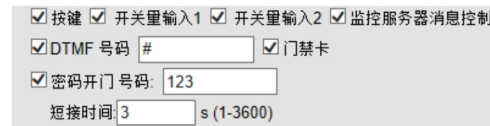

DSS键功能简介:

在使用该按键前，请确保相关的配置选项正确且能使用。登陆设备WEB管理页面设置如下（路径：高级管理页面>可编程键>热线键）。

热线	模式	账号	名称	号码
热线1:	快速拨号	账号1	测试1	8888
热线2:	DTMF二次拨号	账号1	门锁密码	2486
热线3:	Intercom	账号1	测试2	3333
热线4:	快速拨号	账号1		

模式:

快速拨号 - 在快速拨号模式下，可以定义该通话是否允许被立即发出。

对讲 - 在对讲模式下，如果对端IP话机支持对讲功能，则可以实现自动接听通话。

名称&号码 - 可填入被叫的名称和号码或地址。

按键	按DSS键可触发继电器。
输入1 或 2	逻辑输入接口1或2触发继电器。
服务器控制	使用API命令触发继电器，该设置请与联系我们索要开发文档。
DTMF号码	在通话过程中，收到对端设备传送过来的DTMF密码，如果正确，则触发继电器。
开门密码	设置并使用改密码可触发继电器进行开门控制。
短路时间	继电器计时器。

广州亿景通信技术有限公司
地址: 广州市天河区东圃黄村路51号粤安工业园C栋四楼
网站: <http://www.escene.cn>



IP Intercom Doorphone IS/IV720

Quick Installation Guide

Thank you for purchasing ESCENE IP Intercom doorphone. All of ESCENE IP Intercom doorphone products have been tested strictly before shipping. ESCENE IP Intercom doorphone is widely used in office, school, airport, etc. In order to facilitate installing, modulation and running. Please read this manual carefully before setting.

IP Doorphone Topological Graph

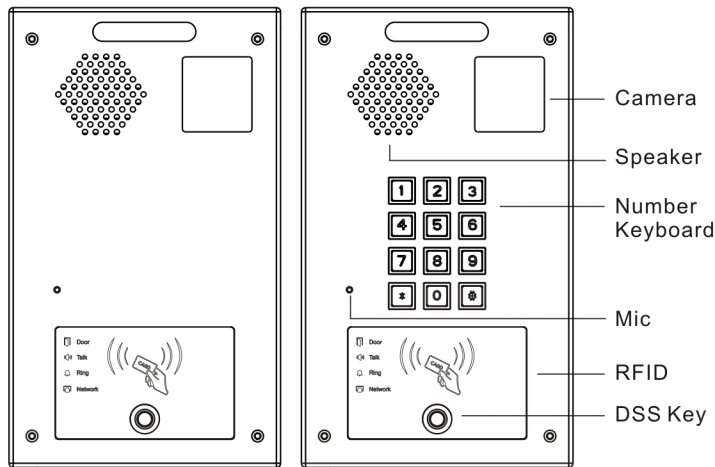

- | | | | |
|----------|---------------|---------|---|
| Output 1 | Electric Lock | Input 1 | Door Magnetic Switch or Infrared Sensor |
| Output 2 | Alarm Light | Input 2 | Vibration Sensor or Emergency Key |

Packing List:

List	Quantity
Doorphone	1
Quick Installation Guide	1
Installation Guide	1
Mounting Dimensions Map	1
Connector	2
Screw and tool	1 Packet

Factory IP Address:

This equipment's factory IP address is using static IP (e.g. <http://192.168.1.100>, Gate way: 192.168.1.1), the default user name: root, password: root. In order to avoid network problem, please carefully adjust, then install the equipment under the network environment.
 Note: the main control board has a light touch key which could be long pressed after 20 seconds to reset the factory defaults, then the original configuration will be deleted.

<http://192.168.1.100/user.asp> is easy web management.
<http://192.168.1.100/home.asp> is all-round web management.

Add SIP Account:

Easy or All-round web management can setting the SIP server address, port, user name, password and SIP user with assigned SIP account parameters.

The screenshot shows the 'SIP Account' configuration page. It includes fields for:

- Enable:
- Display Name: []
- Username: 3004
- Password: []
- SIP Server: 192.168.0.7
- Polling interval time of registration: 32 s (Default value: 32s, range: 20s-60s)
- Register Expiration Time: 3600 (Default: 3600s, Min: 40s)

Easy web management

All-round web management:
 Current location : SIP Account > Account 1

Current location: SIP Account > Account 1

The device has two of RELAY OUTPUT and LOGICAL INPUT interface. The RELAY OUTPUT interface can be under control for DSS Key/Logical Input/Server Control/DTMF.

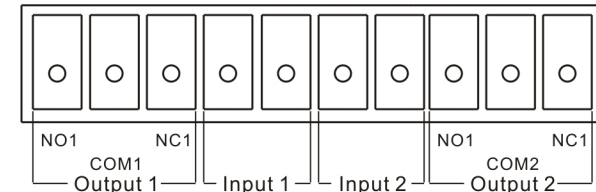

Two Short Circuits Output & Input Example Figure

Two Short Circuits Output Configuration Method

Login Easy web management or All-round web management, as shown in the figure below. The output port settings:

The screenshot shows the 'Output1' configuration page with the following settings:

- Press Key
- InPut1
- InPut2
- Server Control
- DTMF Number # []
- DoorCard
- Touch key Open Door Number: 123
- Short Circuit Time: 3 s (1-3600)

DSS KEY FUNCTION USAGE:

Before using this key, please ensure that the related configuration is correct and can be used. Login the equipment webpage to configure (All-round WEB Management > Programmable Keys > Memory Keys).

Key	Mode	Account	Name	Number
Key1:	Speed Dial	Account1	NICK	1111
Key2:	DTMF	Account1	Opendoor	88
Key3:	Intercom	Account1		
Key4:	Speed Dial	Account1		

Mode:

Speed Dial - In Speed dial mode can define whether this call is allowed to be hang up by re-press the speed dial.

Intercom - In Intercom mode, if the caller's IP phone support intercom feature, can realize auto answer.

Name & Number - Fill the called party's Name and SIP account or address.

Press Key	Press the dial button to trigger the relay.
Input1 or 2	Shortcut the input1 logic to trigger the relay.
Ser Control	Use API command to trigger the relay. Ask us for develop manual please.
DTMF NO.	Pressing DTMF key to trigger the relay when the phone talking.
Open Door NO.	Setting and use this Open Door Number can open the door.
Short Circuit Time	The relay circuit timer.

ESCENE COMMUNICATION CO.,LTD.
 Address: Floor 4 Building C YueAn Industrial Park No.51Huangcun Road Tianhe District Guangzhou China
 Web: <http://www.escene.cn/en/>

